

ORDINANCE NO 2017-2

AN ORDINANCE OF THE CITY OF JAMAICA BEACH, TEXAS, TO ADOPT A 35 MILES PER HOUR SPEED LIMIT ON THE PORTION OF STATE HIGHWAY FM 3005 WITHIN THE CITY LIMITS IN THE CITY OF JAMAICA BEACH; MAKING VARIOUS FINDINGS AND PROVISIONS RELATED TO THE SUBJECT.

WHEREAS, the City Council of this City, as the governing body thereof, has the authority under Section 545.356 of the Texas Transportation Code to alter by ordinance the prima facie speed limits on officially designated highway of the state highway system when it determines from the results of an engineering and traffic investigation that the prima facie speed limit set forth in Subchapter H of the said Code is unreasonable or unsafe on a part of the state highway system, and may determine and declare a reasonable and safe prima facie speed limit on that part of the state highway system; and

WHEREAS, by Ordinance 89-3, the City Council of this City did determine and declare, upon the basis of an engineering and traffic investigation, and pursuant to the authority heretofore granted under Article 670ld of the Texas Civil Statutes, a prima facie speed limit of 35 miles per hour on FM 3005 from the east city limit to the west city limit to be reasonable and safe, and fixed said rate of speed as the prima facie speed limit upon said portion of the said highway; and

WHEREAS, signs giving notice of the said 35 mile per hour speed limit were subsequently erected, have been in place for many years, and remain in place inside the east and west city limits of the City, and within the limits of the City; and

WHEREAS, a new traffic and engineering study was conducted by the Texas Department of Transportation in 2017, and the Texas Department of Transportation has provided the City with a written report and Speed Zone Strip Map in that regard, wherein the said Department recommends no change in the speed zone and 35 mile per hour prima facie speed limit as reflected in Ordinance 89-3; and

WHEREAS, the City has considered the said report and Speed Zone Strip Map in adopting and approving this Ordinance:

NOW THEREFORE, BE IT ORDAINED BY THE CITY COUNCIL OF THE CITY OF JAMAICA BEACH, TEXAS:

SECTION 1. Upon the basis of the 2017 engineering and traffic investigation done by the Texas Department of Transportation, a prima facie speed limit for vehicles of 35 miles per hour is hereby determined and declared to be reasonable and safe and is hereby fixed as the prima facie speed limit for vehicles traveling upon FM 3005 within the city limits of Jamaica Beach, when signs giving notice of such prima facie speed limit are in place;

SECTION 2. Any person operating a vehicle at a speed in excess of the prima facie speed limit hereby adopted shall be guilty of a misdemeanor and upon conviction thereof shall be fined in an amount not to exceed Two Hundred Dollars (\$200.00).

APPROVED AND ADOPTED this the 15th day of May, 2017.



STEVE SPICER, MAYOR

ATTEST:



LUPE RUSHING, CITY SECRETARY



P.O. BOX 1386 | HOUSTON, TEXAS 77251-1386 | (713) 802-5000 | WWW.TXDOT.GOV

April 24, 2017

John Brick
City Administrator, City of Jamaica Beach
5264 Jamaica Beach
Jamaica Beach, Texas 77554

RE: Request for Speed Study – FM 3005 – Galveston County

Dear Mr. Brick:

Our office has completed a Speed Zone Study along FM 3005 within the City of Jamaica Beach. The attached Speed Zone Strip Map 5735D shows the speed study sets by the 85th Percentile Method, which represents the speed of the majority of drivers travelling on the particular segment of the roadway.

To ensure a true reflection of a normal traffic situation, the speed checks are conducted on average weekdays during off-peak hours and under favorable weather conditions. The data collected typically shows roadway features such as curves, crash history, cross streets, school crossings and sites that generate traffic. The observed free-flowing speed for vehicles is tallied and the 85th percentile speed is calculated using gathered information. The legend below the strip map explains the data collected.

The study conducted supports the current speed zone as reflected on the current city ordinance on file, therefore no change in speed is recommended at this time.

Should you have questions please contact Gaurang Pandit, Transportation Engineer Supervisor at (713) 802-5856 or Rogelio Rubico at (713) 802-5182.

Sincerely,

Ugonna U. Ughanze, P.E.
Director of Transportation Operations
Houston District

Attachments

cc: Lupe Rushing – City of Jamaica Beach
Joel Clarke, P.E. – City of Jamaica Beach
Gaurang S. Pandit, P.E.
Rogelio R. Rubico, P.E.
Roberto Lewis

OUR VALUES: People • Accountability • Trust • Honesty

OUR MISSION: Through collaboration and leadership, we deliver a safe, reliable, and integrated transportation system that enables the movement of people and goods.

An Equal Opportunity Employer

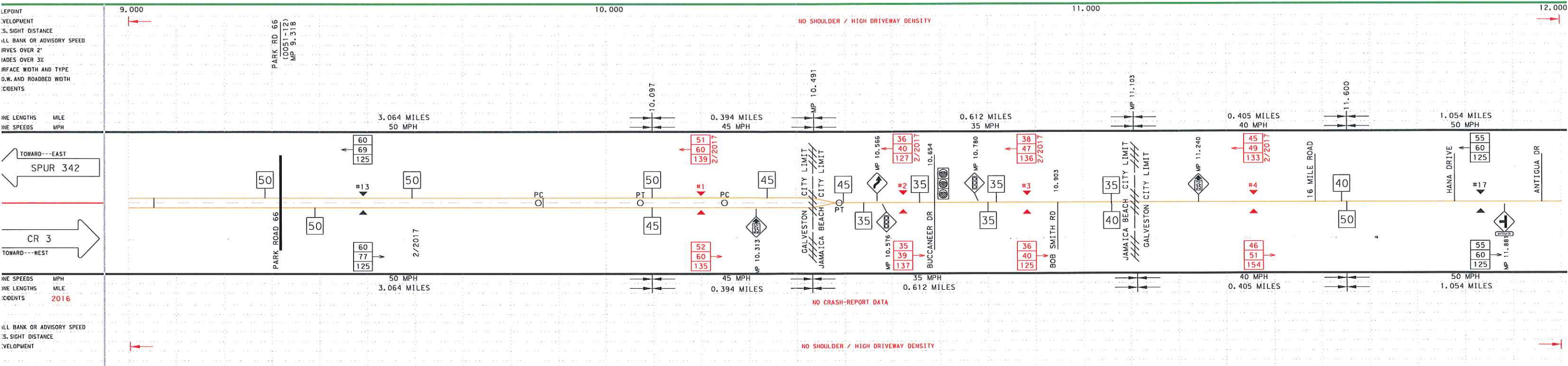

TRIBUTARY	HOUSTON	COUNTY	GALVESTON	WRITE NO.	DATE	///
RIGHTWAY	FM 3005	CITY	GALVESTON/JAMAICA BEACH	REPLACES	DATE	///
DATE OF SURVEY	2/2017	SCALE	5" = 1 MILE	REPLACED BY	DATE	///
				CANCELED BY	DATE	///

LIMITS OF ZONE						
SECTION ONE			SECTION TWO			
STATION	CONT. & SECT.	PROJECT	STATION	CONT. & SECT.	PROJECT	PROJECT
BEGINS 0.000	0051-09		BEGINS			
ENDS 22.003	0051-09		ENDS			

LIMITS OF ZONE			
SECTION THREE		SECTION FOUR	
BEGINS	ENDS	BEGINS	ENDS
STA. OR M.P.	CONT. & SECT.	STA. OR M.P.	CONT. & SECT.
PROJECT	PROJECT	PROJECT	PROJECT

SPEED CHECK BLOCK:

- 68 - 85th PERCENTILE SPEED
- 74 - TOP SPEED MEASURED
- 85 - NUMBER OF CARS CHECKED

65 - TRIAL RUN CONDUCTED

- - FATAL ACCIDENT
- - PERSONAL INJURY ACCIDENT
- ⊖ - PROPERTY DAMAGE ACCIDENT
- - SECTION ZONED BY COMMISSION MINUTE ORDER
- 55 - EXISTING SPEED LIMIT SIGN
- - SECTION ZONED BY CITY ORDINANCE
- #N - SPEED CHECK STATION
- ★ - EXCEEDED STATEWIDE AVERAGE ACCIDENT
- ⊖ - EXISTING TRAFFIC SIGNAL
- ⊖ - EXISTING FLASHING BEACON
- ⊖ - EXISTING POLE
- ⊖ - PROPOSED SIGN
- PC - POINT OF CURVE
- PT - POINT OF TANGENT

Proposed signs and symbols:

- S5-1: SCHOOL SPEED LIMIT 35 WHEN FLASHING
- R2-1: SPEED LIMIT 55
- Proposed Speed Limit Sign (TYP)
- Proposed School Zone When Flashing with Beacons (TYP)
- Proposed Reduced Speed Ahead Sign (TYP)
- W3-5: Warranted Speed

TEXAS DEPARTMENT OF TRANSPORTATION

SPEED ZONE

STRIP MAP 5735 D